

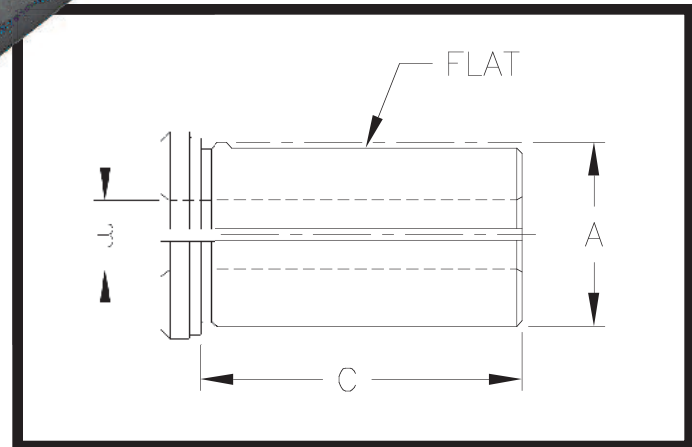

Toolholder Bushing Type “B”

These split Type B Bushings are manufactured with flexible manufacturing systems, for all Types and sizes of CNC Lathes and Chucks; are Heat Treated and precision ground concentric. It is used to adapt Drills, Boring Bars, and other Shank Tools. Select the O.D. size that fits your machine and order from the chart below.

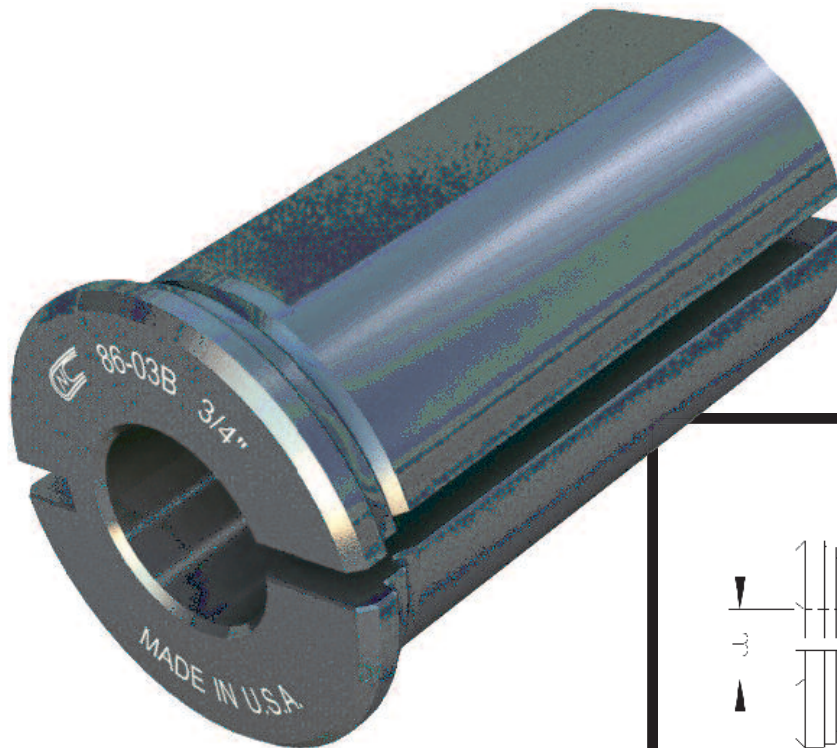

CNC PART NUMBER	BUSH DIA.		STANDARD BORE SIZES STOCKED		SPECIAL BORE SIZES AVAILABLE		LENGTH UNDER HEAD
	A		B		MIN.	MAX.	C
	IN.	MM	IN.	MM			
CNC 86-01B	3/4	20	1/4, 5/16, 3/8, 1/2	6, 8, 10, 12	3/16	5/8	1 1/2
CNC 86-02B	1	25	3/8, 1/2, 5/8, 3/4	10, 12, 16, 20	3/16	7/8	1 3/4
CNC 86-12B	1 1/4	32	3/8, 1/2, 5/8, 3/4, 7/8, 1	10, 12, 16, 20, 25	3/16	1	2 1/8
CNC 86-03B	1 1/2	40	3/8, 1/2, 5/8, 3/4, 7/8, 1, 1 1/4	10, 12, 16, 20, 25, 32	3/16	1 1/4	2 1/2
CNC 86-04B	1 3/4	45	1/2, 5/8, 3/4, 7/8, 1, 1 1/4, 1 1/2	10, 12, 16, 20, 25, 32, 40	1/4	1 1/2	3
CNC 86-05B	2	50	1/2, 5/8, 3/4, 7/8, 1, 1 1/4, 1 1/2, 1 3/4	12, 16, 20, 25, 32, 40	1/2	1 3/4	3 1/2
CNC 86-06B	2 1/2	65	1/2, 5/8, 3/4, 7/8, 1, 1 1/4, 1 1/2, 1 3/4, 2, 2 1/4	20, 25, 32, 40, 45, 50	1/2	2 1/4	4
CNC 86-07B	3	80	1, 1 1/4, 1 1/2, 1 3/4, 2, 2 1/4, 2 1/2	25, 32, 40, 45, 50, 60, 65	5/8	2 1/2	4 1/2
CNC 86-08B	3 1/2	90	1, 1 1/4, 1 1/2, 1 3/4, 2, 2 1/4, 2 1/2, 3	25, 32, 40, 45, 50, 60, 65	5/8	3	5 1/4

*Special sizes available to fit your machine specifications: inch-metric, metric-inch, or metric-metric.

*All Orders ship standard in inch sizes. If required; please specify metric O.D. or I.D., when ordering.