

CALL US TOLL FREE TO ORDER:  
**(800) 423-5145**

## Turning Toolholder – Form B8

Left-Hand Long-Inverted

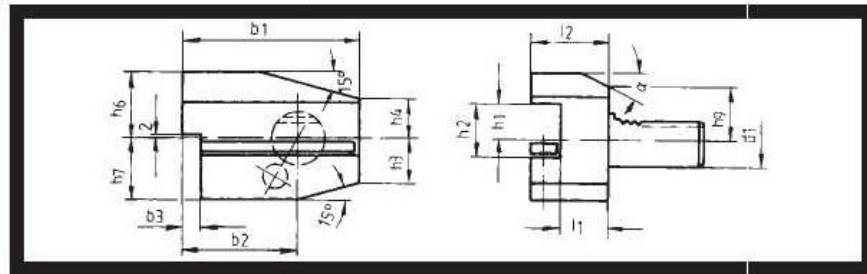

| PART NUMBER     | $d_1$ | $b_1$ | $b_2$ | $b_3$ | $h_1$ , in | $h_1$ , mm | $h_2$ | $h_3$ | $h_4$ | $h_6$ | $h_7$ | $h_9$ | $L_1$ | $L_2$ | $\alpha$ |
|-----------------|-------|-------|-------|-------|------------|------------|-------|-------|-------|-------|-------|-------|-------|-------|----------|
| CNC86 28.1612   | 16    | 58    | 39    | 5     | 1/2        | 12         | 17    | 15    | 15    | 22    | 20    | 18    | 13    | 24    | 30       |
| CNC86 28.1612.1 | 16    | 58    | 39    | 5     | 1/2        | 12         | 17    | 15    | 15    | 22    | 20    | 18    | 23    | 34    | 30       |
| CNC86 28.2016   | 20    | 75    | 50    | 7     | 5/8        | 16         | 22    | 19    | 19    | 30    | 25    | 23    | 16    | 30    | 30       |
| CNC86 28.2016.1 | 20    | 75    | 50    | 7     | 5/8        | 16         | 22    | 19    | 19    | 30    | 25    | 23    | 26    | 40    | 30       |
| CNC86 28.2516   | 25    | 75    | 50    | 7     | 5/8        | 16         | 22    | 22.5  | 22.5  | 30    | 25    | 25    | 16    | 30    | 30       |
| CNC86 28.2516.1 | 25    | 75    | 50    | 7     | 5/8        | 16         | 22    | 22.5  | 22.5  | 30    | 25    | 25    | 26    | 40    | 30       |
| CNC86 28.3020   | 30    | 100   | 65    | 10    | 3/4        | 20         | 29    | 26    | 22    | 38    | 35    | 28    | 22    | 40    | 25       |
| CNC86 28.3020.1 | 30    | 100   | 65    | 10    | 3/4        | 20         | 29    | 26    | 22    | 38    | 35    | 28    | 42    | 60    | 25       |
| CNC86 28.3025   | 30    | 100   | 65    | 10    | 1          | 25         | 34    | 35    | 30    | 48    | 42    | 40    | 22    | 47    | 25       |
| CNC86 28.4025   | 40    | 118   | 75.5  | 12.5  | 1          | 25         | 34    | 42    | 35    | 60    | 50    | 32.5  | 22    | 44    |          |
| CNC86 28.5025   | 50    | 130   | 80    | 16    | 1          | 25         | 34    | 42    | 35    | 60    | 50    |       | 30    | 55    |          |
| CNC86 28.5032   | 50    | 130   | 80    | 16    | 1 1/4      | 32         | 41    | 42    | 35    | 60    | 50    |       | 30    | 55    | 30       |
| CNC86 28.6032   | 60    | 145   | 82.5  | 16    | 1 1/4      | 32         | 41    | 46    | 42.5  | 62.5  | 62.5  |       | 30    | 60    |          |
| CNC86 28.8040   | 80    | 190   | 110   | 20    | 1 1/2      | 40         | 53    | 60    | 55    | 80    | 80    |       | 40    | 75    |          |

Expanding Collets  
 Tool Blocks - Collet  
 Chucks - Special  
 Tooling



**ROVI**  
 PRODUCTS INC.  
 RoviProducts.com